

Access Control Composite

Riser/Plenum

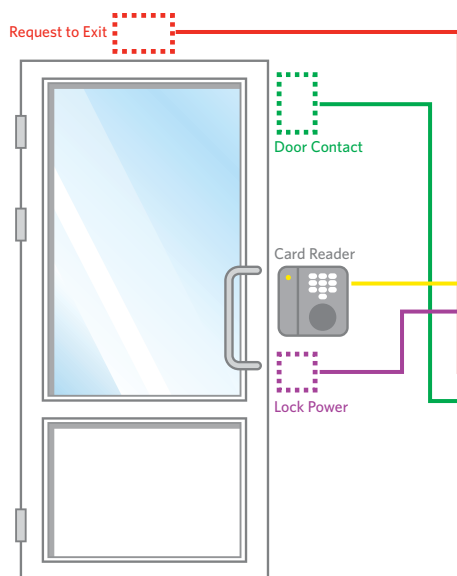
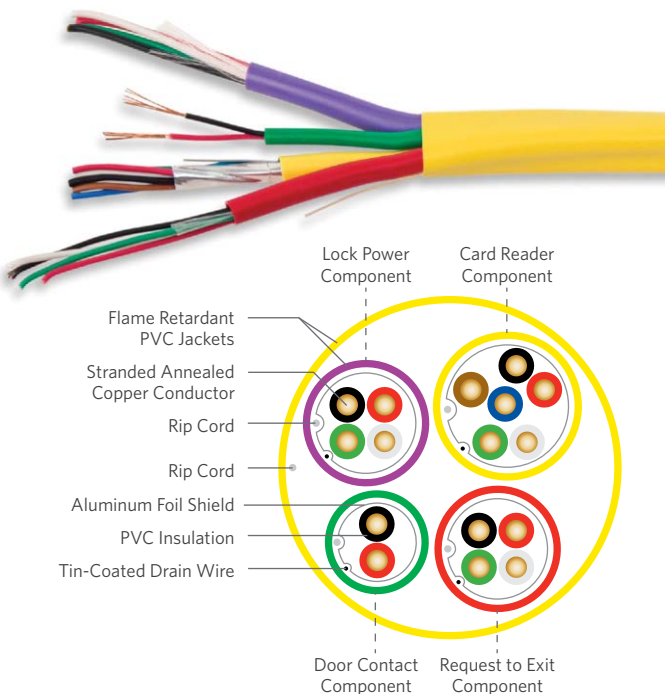

PRODUCT DESCRIPTION

The Access Control Composite series combines four components that are required for card reader/keypad, door contact, request to exit and lock power device connectivity in a single cable. These composites are offered with an option to shield all components or just the single card reader component. Both riser and plenum jacket constructions are available.

APPLICATIONS

- Access control

FEATURES

- Four components in a single jacket
- Twisted pair in card reader component
- Jacket rip cord
- Overall shield (where applicable)
- QuickCount marking system in feet and meters

BENEFITS

- Save labor costs with a one cable run
- Satisfies requirements of RS-232 and RS-485 protocols
- Easy to open; saves cable preparation time
- Electromagnetic Interference (EMI) protection
- Provides remaining length of cable on spool resulting in less scrap

COMPONENT COLOR CODING AND APPLICATION

Component Number	Cable Type	Application	Component Jacket Color
1	18 AWG x 4 conductors	Lock Power	Purple
2	22 AWG x 3 twisted pairs	Card Reader	Yellow
3	22 AWG x 4 conductors	Request to Exit	Red
4	22 AWG x 2 conductors	Door Contact	Green

ENVIRONMENTAL SPECIFICATIONS

Operation	-4°F to +167°F (-20°C to +75°C)
Installation	+32°F to +149°F (0°C to +65°C)

COMPOSITE SPECIFICATIONS

Outer Jacket	Riser: Flame Retardant (FR) PVC Plenum: FR PVC
Jacket Marking	Example: XXXXFT/XXXXM SUPERIOR ESSEX ACCESS CONTROL CABLE DOOR / ZONE A B C D E / 0 1 2 3 4 5 6 7 8 9 18/4C + 22/3PR SHLD + 22/4C + 22/2C (UL) CMR/CL3R 75°C "ROHS COMPLIANT"
Package	Wood reel
Performance Compliance	NEC Article 725 NEC Article 800 NEC Article 760 UL 13 CL3R/CL3P UL 444 CMR/CMP UL 1424 FPLR/FPLP UL 1666 NFPA 262 California State Fire Marshall RoHS-compliant
NRTL Programs	UL Listed CL3R, CMR, FPLR UL Listed CL3P, CMP, FPLP

COMPONENT SPECIFICATIONS

Conductor/Pair Count	Available with 2 through 4 conductors and available with 3 twisted pairs
Conductor	Fully annealed, stranded bare copper
AWG (mm)	Available in 18 (1.16) and 22 (0.64)
Insulation	Low smoke PVC
Shield (where applicable)	1-mil overall aluminum polyester foil shield with 24 AWG (0.51 mm) solid tinned copper drain wire
Component Jacket	Riser: Flame Retardant (FR) PVC Plenum: FR PVC
Component Jacket Marking	Example: LOCK POWER DOOR / ZONE A B C D E / 0 1 2 3 4 5 6 7 8 9 18AWG/4C PLENUM

PART NUMBERS AND PHYSICAL CHARACTERISTICS

Listing	Part Number ¹	Component Number	Application	Component Description	Insulation Colors	Component Jacket Color	Outer Jacket Color	Nominal Diameter in (mm)	Approx. Weight lbs/kft (kg/km)
CMR/CL3R	AC-A1x-55	1	Lock Power	18 AWG x 4 conductors, non-shielded	Black, Red, White, Green	Purple	Green	0.46 (11.7)	105 (156)
		2	Card Reader	22 AWG x 3 twisted pairs, shielded	Black/Red, White/Green, Brown/Blue	Yellow			
		3	Request Exit	22 AWG x 4 conductors, non-shielded	Black, Red, White, Green	Red			
		4	Door Contact	22 AWG x 2 conductors, non-shielded	Black, Red	Green			
CMR/CL3R	AC-A2x-55	1	Lock Power	18 AWG x 4 conductors, shielded	Black, Red, White, Green	Purple	Green	0.47 (11.9)	110 (164)
		2	Card Reader	22 AWG x 3 twisted pairs, shielded	Black/Red, White/Green, Brown/Blue	Yellow			
		3	Request Exit	22 AWG x 4 conductors, shielded	Black, Red, White, Green	Red			
		4	Door Contact	22 AWG x 2 conductors, shielded	Black, Red	Green			
CMP/CL3P	AC-A1x-68	1	Lock Power	18 AWG x 4 conductors, non-shielded	Black, Red, White, Green	Purple	Yellow	0.46 (11.7)	105 (156)
		2	Card Reader	22 AWG x 3 twisted pairs, shielded	Black/Red, White/Green, Brown/Blue	Yellow			
		3	Request Exit	22 AWG x 4 conductors, non-shielded	Black, Red, White, Green	Red			
		4	Door Contact	22 AWG x 2 conductors, non-shielded	Black, Red	Green			
CMP/CL3P	AC-A2x-68	1	Lock Power	18 AWG x 4 conductors, shielded	Black, Red, White, Green	Purple	Yellow	0.47 (11.9)	110 (164)
		2	Card Reader	22 AWG x 3 twisted pairs, shielded	Black/Red, White/Green, Brown/Blue	Yellow			
		3	Request Exit	22 AWG x 4 conductors, shielded	Black, Red, White, Green	Red			
		4	Door Contact	22 AWG x 2 conductors, shielded	Black, Red	Green			

PACKAGING OPTIONS

	Wood Reel	
	1,000'	500'
¹ Replace "x" with:	2	3