

How do you achieve compliance and increase peace of mind?

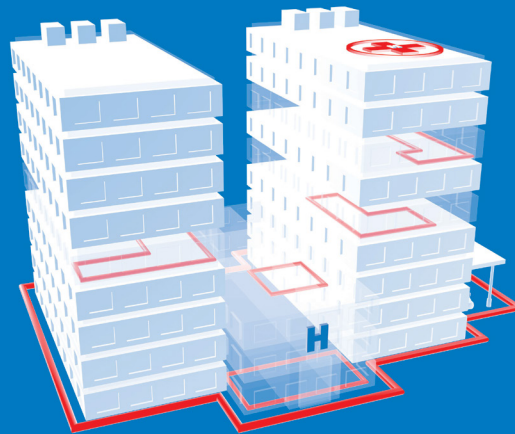

HEALTHCARE FACILITY RISK MANAGEMENT

Healthcare facilities contain a number of complex areas that require a balance of specialised attention and integration into an overall risk management strategy. Securing patient-centred, pharmaceutical and biomedical zones are essential to improving patient satisfaction and achieving regulatory compliance.

Deploying a layered security strategy can provide you with the ability to deter, detect, delay, defend and deny in every area of your healthcare facility.

SECURITY OPEN ARCHITECTURE

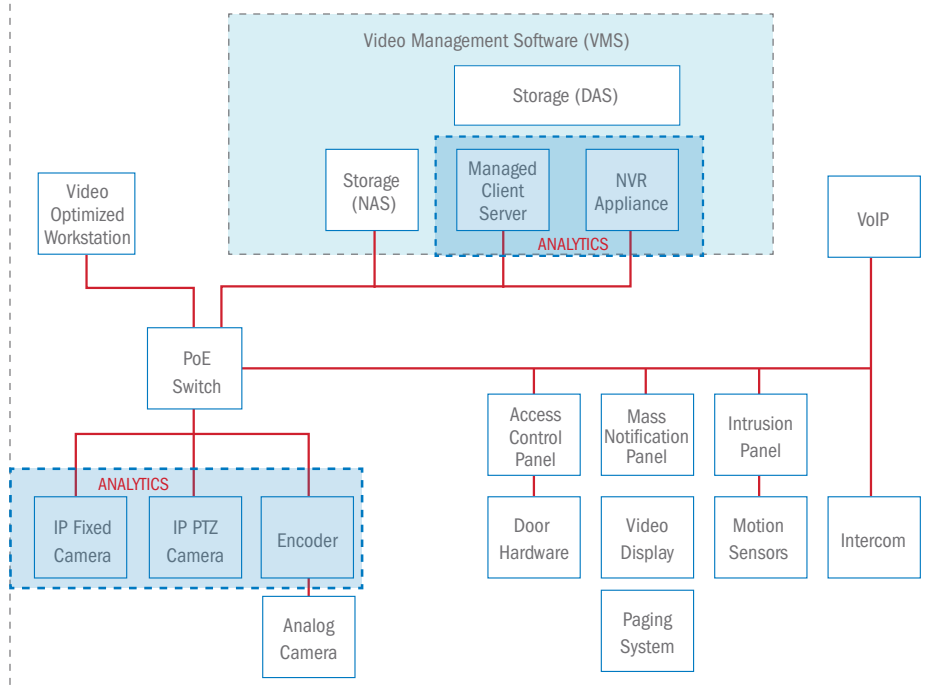

WHAT WE HEAR

Healthcare stakeholders are dealing with a variety of challenges:



Creating **SAFE** environments for patients and staff



Preventing **THEFT** of medicine and radiological materials



Achieving **REGULATORY COMPLIANCE**



Preventing **CYBERTHREATS** to patient records



Limiting physical building and network **ACCESSIBILITY**

A COVERED HEALTHCARE ENTITY MUST:



- Limit physical access to its facilities while ensuring that authorised access is allowed.
- Implement policies and procedures to specify proper use of and access to workstations and electronic media.

Source: The Health Insurance Portability and Accountability Act of 1996 (HIPAA)

Infrastructure as a Platform
by Anixter

Infrastructure as a Platform by Anixter provides a practical, configurable and integrated approach to deploy physical security infrastructure into your healthcare environment.

SIX LAYERS OF PHYSICAL SAFETY AND SECURITY

The Anixter Approach

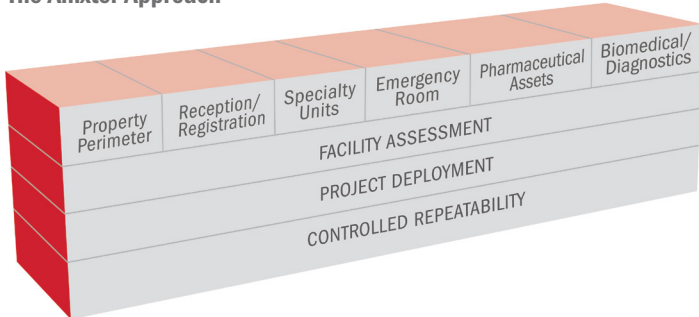

In addition to the micro-segmentation strategy for enhanced logical security, our approach provides healthcare facility managers with a clear set of guidelines and best practices for a macro-segmentation strategy for enhanced physical security.

- Property Perimeter**
 Determine vulnerability areas around the property edge to deter external threats.
- Reception/Registration Area**
 Control the flow of visitors and patients to the facility and validate various levels of staff authorisation.
- Specialty Units**
 Protect patients and comply with privacy regulations with attention to complex specialty units.
- Emergency Room**
 Improve staff safety and care through effective management of high-stress and high-traffic emergency settings.
- Pharmaceutical Assets**
 Achieve regulatory compliance and loss prevention by monitoring access to and intrusion into pharmaceutical zones.
- Biomedical/Diagnostics**
 Protect valuable equipment and potentially harmful materials in biomedical and diagnostic areas.



YOUR RISK MANAGEMENT PLATFORM

Anixter Engagement Process

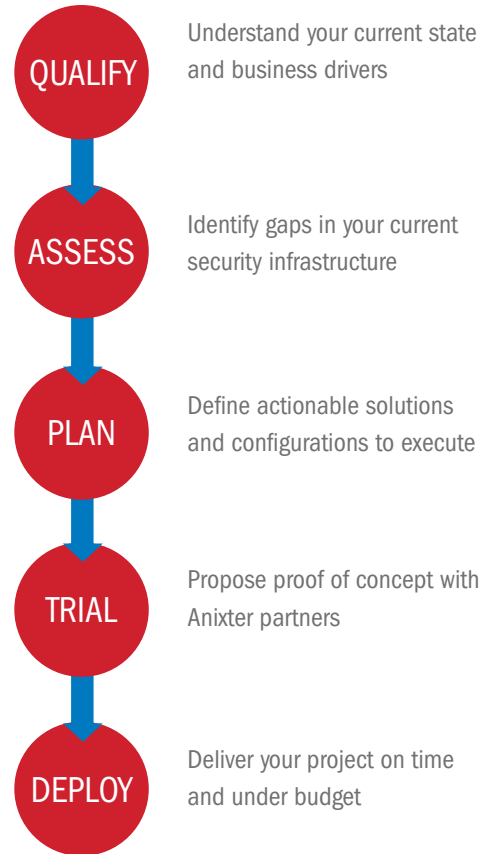

You can further enable interoperability by leveraging our expertise in technology sourcing, inventory management, product enhancement, logistics and eCommerce tools.

PRODUCT SOLUTIONS

- Video and access control software
- Surveillance cameras
- Servers and storage
- Ethernet switches
- Electronic and mechanical door hardware
- Keypads and readers
- Intelligent cabinet locker systems
- Radiological sensors
- Automatic door motion sensors
- Fire pull stations
- Intrusion motion detectors

FOR MORE INFORMATION VISIT [ANIXTER.COM/HEALTHCARE/EMEA](https://anixter.com/healthcare/emea)

At Anixter, we enable the connected world. By building, connecting, protecting and powering valuable assets and critical infrastructures, we help to sustain and grow businesses and communities worldwide. We accomplish this by offering full-line solutions, technical intelligence, supply chain expertise and an unmatched global distribution network.