

PRODUCT SOLUTIONS BRIEF
PANDUIT

HEALTHCARE FACILITY NETWORK PERFORMANCE

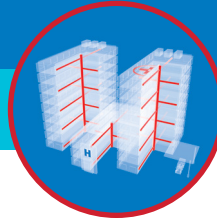

Through our strong global partnerships and alliances with manufacturers like Panduit, we are able to present you with the following offering to meet your healthcare facility requirements.

TX6A™ Category 6A UTP Field Term RJ45 Plug

The TX6A Category 6A UTP Field Term RJ45 Plug is a simple-to-attach plug for field termination of 4-pair unshielded twisted-pair cable. Providing Category 6A performance, the TX6A™ plug is also compatible with Category 6 and 5e systems. The two-piece straight and up/down angled TX6A(TM) plug terminates 4-pair, 22-26 AWG, 100 ohm unshielded twisted-pair cable and uses proven TG-style forward motion termination technology to optimize performance by maintaining cable pair geometry while eliminating conductor untwist.



The simple-to-attach TX6A Field Term Plug, available in both straight and angled versions, use Panduit's familiar TG-style termination to optimize performance.

The simple-to-attach plug is ideal for connecting the increasing number of network-powered devices, including:

- Wireless access points
- Power over Ethernet LED lighting
- IP security cameras and motion sensors
- Building access control points
- Network-attached A/V equipment
- Other PoE or HDBaseT-powered devices

CHALLENGE SOLVERS

- Simple two-piece assembly is easy to handle during field installation, saving time and reducing termination errors.
- 45-degree up/down angled version provides improved cable routing in tight spaces.
- Slim plug profile makes it easy to fit in high-density or tight port spaces.
- Re-terminate up to 20 times with no additional parts, providing convenience and cost savings.
- Compact termination tool is lightweight and robust, making it easy to carry anywhere.

THE ANIXTER APPROACH

- **Network Flexibility**
Apply open-architecture designs to accommodate your performance requirements for a highly scalable network.
- **Media Selection**
Choose the appropriate physical media from twisted-pair and optical fiber to address high-speed bandwidth requirements.
- **Cabling Topology**
Determine the right choice for an open-architecture environment by adopting healthcare facility wiring and building automation standards.
- **Wireless Mobility**
Determine your migration path for wireless connectivity to support a multiscreen environment.
- **Application Support**
Deploy scalable designs that can support multiple and varied applications over an IP-based structured cabling system.



WHAT WE HEAR

Healthcare stakeholders are dealing with a variety of challenges:



Keeping up with **EVOLVING TECHNOLOGIES**



AMORTIZATION of cabling system investment



Supporting multiple **APPLICATIONS**



Reducing network **DOWNTIME**



Coping with **INCREASING BANDWIDTH**

THE PANDUIT SOLUTION

COMPATIBLE WITH	TERMINATION	PLENUM RATED
Category 6A Category 6 Category 5e	Familiar TG-style Optimizes performance	UL 2043 Use in air-handling spaces

anixter.com/shoppanduit

Infrastructure as a Platform
by Anixter

Infrastructure as a Platform by Anixter offers a standards-based, physical layer approach that provides a foundation to meet the high-performance networking demands of your healthcare facility.

CONFIGURE

We help you discover and map your specific needs to the best solution.

Single part number works for:

- Category 6A
- Category 6
- Category 5e

BUNDLE

Your validated, preconfigured solutions are packaged and site ready.

- Copper cable
- Tools
- Plenum-rated surface mount box
- J-hooks

DEPLOY

Controlled, repeatable solutions are delivered on time and under budget.

- Custom packaging and labeling
- Time-sensitive delivery options
- Staged project shipping
- Tailored last-mile delivery

PANDUIT TX6A™ CATEGORY 6A UTP FIELD TERM RJ45 PLUG FEATURES

✓ CONNECTING NETWORK DEVICES

- Plenum-rated for use in air-handling spaces, making the plugs ideal for connecting wireless access points, security cameras, motion sensors and other systems
- Slim plug profile and 45-degree angle option means means the plugs easily fit in tight spaces and high-density configurations
- Compatible with all wire gauges 22-26 AWG

✓ EASY INSTALLATION

- Field-friendly two-piece design makes it easy to handle during field installation
- Straight or angled options allows easiest cable routing in the field
- Familiar TG-style termination delivers proven electrical performance and quick installation
- Compact termination tool is lightweight, robust and foldable, making it easy to carry anywhere



The TX6A Field-Term Plug is ideal for connecting the increasing number of network devices, such as wireless access points, security cameras, access control points, PoE lighting and A/V equipment.

> FOR MORE DETAILS VISIT [ANIXTER.COM/SHOPPANDUIT](https://www.anixter.com/shoppanduit)

About Anixter: [anixter.com/aboutus](https://www.anixter.com/aboutus)

Legal Statement: [anixter.com/legalstatement](https://www.anixter.com/legalstatement)

At Anixter, we enable the connected world. By building, connecting, protecting and powering valuable assets and critical infrastructures, we help to sustain and grow businesses and communities worldwide. We accomplish this by offering full-line solutions, technical intelligence, supply chain expertise and an unmatched global distribution network.

1.800.ANIXTER | [anixter.com](https://www.anixter.com)



17T8403NA © 2018 Anixter Inc.

Products. Technology. Services. Delivered Globally.