

PRODUCT SOLUTIONS BRIEF
BELDEN

HEALTHCARE FACILITY NETWORK PERFORMANCE

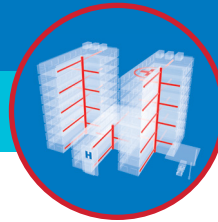

Through our strong global partnerships and alliances with manufacturers such as Belden, we are able to present you with the following offering to meet your specific healthcare requirements.

Bonded-Pair Technology

Belden’s breakthrough Bonded-Pair cables are the result of a patented design that bonds the individual insulated conductors together along their longitudinal axes. This unique physical characteristic results in uniform conductor-to-conductor spacing—a key aspect in consistent electrical performance. Even when a Bonded-Pair cable is subjected to everyday installation stresses such as bending, coiling and pulling, its conductor-to-conductor spacing remains stable. This technology is featured in a family of cables, cable assemblies and modular cords, and supports demanding environments and installations.

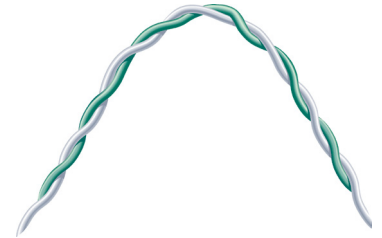

A Bonded-Pair cable can be manipulated without causing performance-robbing gaps between the conductors as a pair.

CHALLENGE SOLVERS

- Technology with 10GXS cable delivers 10 Gbps and 100 W PoE over full 100 meter length at up to 60°C, takes up 25 percent less space, weighs 25 percent less and supports Wave 2 Wireless, next generation security, high-noise and high-performance environments.
- Bonded-Pair cables are more resistant to the effects of installation and termination, so fewer failures are encountered compared to nonbonded-pair cables.
- Bonded-Pair patch cords are the only patch cords on the market that pass the Telecommunications Industry Association’s (TIA) stringent mechanical stress test, which improves performance even in the most extreme of patching conditions.

THE ANIXTER APPROACH

- **Network Flexibility**
Apply open-architecture designs to accommodate your performance requirements for a highly scalable network.
- **Media Selection**
Choose the appropriate physical media from twisted-pair and optical to address high-speed bandwidth requirements.
- **Cabling Topology**
Determine the right choice for an open-architecture environment by adopting healthcare facility wiring and building automation standards.
- **Application Support**
Deploy scalable designs that can support multiple and varied applications over an IP-based structured cabling system.

THE BELDEN SOLUTION

COPPER CABLING	PATCH CORDS	PRETERMINATED ASSEMBLIES
Category 6A Category 6 Category 5e	Category 6A Category 6 Category 5e	Category 6A Category 6

anixter.com/shopbelden



WHAT WE HEAR

Healthcare stakeholders are dealing with a variety of challenges:



Keeping up with **EVOLVING TECHNOLOGIES**



AMORTIZATION of cabling system investment



Supporting multiple **APPLICATIONS**



Reducing network **DOWNTIME**



Coping with **INCREASING BANDWIDTH**

Infrastructure as a Platform
by Anixter

Infrastructure as a Platform by Anixter offers a standards-based, physical layer approach that provides a foundation to meet the high-performance networking demands of your healthcare facility.

CONFIGURE

We help you discover and map your specific needs to the best solution.

- Cable length
- Connector type
- Jacket color
- Fire rating

BUNDLE

Your validated, preconfigured solutions are packaged and site ready.

- REVConnect
- KeyConnect outlets
- KeyConnect panels
- Racks and enclosures

DEPLOY

Controlled, repeatable solutions are delivered on time and under budget.

- Custom packaging and labeling
- Time-sensitive delivery options
- Staged project shipping
- Tailored last-mile delivery

BELDEN BONDED-PAIR FEATURES

✓ REDUCES NETWORK DOWNTIME

- Better data transmission pathway results in a lower number of packet resends.
- Cables have a greater immunity to noise.
- Belden Bonded-Pair cables do not gap and therefore exhibit superior return-loss performance characteristics following installation and manipulation.
- Electrical performance of Bonded-Pair cables and assemblies changes little over time and with reuse.

✓ KEEPS UP WITH EVOLVING TECHNOLOGIES

- Comes PoE-ready and is the perfect match with REVConnect jacks and plugs for next-generation applications.
- Features UTP and F/UTP constructions available in all cable categories.
- LP-rated cable helps ensure safe PoE operation to new standard requirements.
- Withstands real-life, heavy-duty situations longer than nonbonded-pair cables and assemblies.



Bonded-Pair cables provide the reliable performance required for high-availability, high-resiliency environments.

> FOR MORE DETAILS VISIT [ANIXTER.COM/SHOPBELDEN](https://www.anixter.com/shopbelden)

About Anixter: [anixter.com/aboutus](https://www.anixter.com/aboutus)
Legal Statement: [anixter.com/legalstatement](https://www.anixter.com/legalstatement)

At Anixter, we enable the connected world. By building, connecting, protecting and powering valuable assets and critical infrastructures, we help to sustain and grow businesses and communities worldwide. We accomplish this by offering full-line solutions, technical intelligence, supply chain expertise and an unmatched global distribution network.

1.800.ANIXTER | [anixter.com](https://www.anixter.com)



18T0456NA © 2018 Anixter Inc.

Products. Technology. Services. Delivered Globally.