

PRODUCT SOLUTIONS BRIEF  
**BELDEN**

**HEALTHCARE FACILITY NETWORK PERFORMANCE**

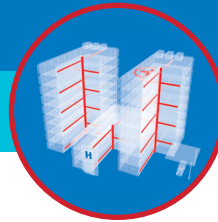

Through our strong global partnerships and alliances with manufacturers such as Belden, we are able to present you with the following offering to meet your specific healthcare requirements.

**REVConnect Connectivity System**

Belden’s REVConnect Connectivity System is a new RJ45 connectivity system that offers versatility by using universal termination core cable and a single reliable and easy termination method for all RJ45 connections. Its unique universal termination process can be used with both shielded and unshielded cables, Category 5e through Category 6A and can accept both jack and plug housings.



Universal REVConnect Core accepts both jack and plug housings.

**CHALLENGE SOLVERS**

- REVConnect uses several patented technologies that offer reliable high performance and power delivery while reducing rework for contractors and associated rework risks.
- The universal core can be terminated onto shielded and unshielded cables and terminates as quickly on Belden Bonded-Pair cable as nonbonded-pair cable. Core and housing technologies make the connectivity system highly reliable, easy and versatile.
- Because core cables can be terminated prior to deciding if a jack or plus housing will be used and before selecting the jack color, REVConnect allows contractors to change their method of deployment to terminated cables as they are installed, ensuring they meet project timelines.

**THE ANIXTER APPROACH**

- **Network Flexibility**  
Apply open architecture designs to accommodate your performance requirements for a highly scalable network.
- **Media Selection**  
Choose the appropriate physical media from twisted pair, optical fiber and direct-attach cables to address high-speed bandwidth requirements.
- **Cabling Topology**  
Determine the right choice for an open architecture environment by adopting healthcare facility wiring and building automation standards.
- **Application Support**  
Deploy scalable designs that can support multiple and varied applications over an IP-based structured cabling system.

**THE BELDEN SOLUTION**

COPPER CABLING	PATCH CORDS	PATCH PANELS
Category 6A Category 6 Category 5e	Category 6A Category 6 Category 5e	Flat Angled Ultra-high density

[anixter.com/shopbelden](http://anixter.com/shopbelden)



**WHAT WE HEAR**

Healthcare stakeholders are dealing with a variety of challenges:



Keeping up with **EVOLVING TECHNOLOGIES**



**AMORTIZATION** of cabling systems



Supporting multiple **APPLICATIONS**



Reducing network **DOWNTIME**



Coping with **INCREASING BANDWIDTH**

**Infrastructure as a Platform**  
by Anixter

Infrastructure as a Platform by Anixter offers a standards-based, physical layer approach that provides a foundation to meet the high-performance networking demands of your healthcare facility.

## CONFIGURE

We help you discover and map your specific needs to the best solution.

- Cable length
- Connector type
- Jacket color
- Fire rating

## BUNDLE

Your validated, preconfigured solutions are packaged and site ready.

- Bonded-Pair cables
- KeyConnect outlets
- KeyConnect panels
- Racks and enclosures

## DEPLOY

Controlled, repeatable solutions are delivered on time and under budget.

- Custom packaging and labeling
- Time-sensitive delivery options
- Staged project shipping
- Tailored last-mile delivery

### BELDEN REVCONNECT FEATURES

#### ✓ REDUCES NETWORK DOWNTIME

- 1- Jacks and plugs terminate the same way and interchange in seconds.
- Termination time is reduced by up to 60 percent versus traditional connectivity.
- Patented technologies deliver reliable connections, moving standard rework time from 5 percent to under 1 percent.
- The Universal Tool is the only tool needed for all terminations, including cable preparation.
- With no pair separation required, Bonded-Pair cable advantages are maintained through this highly reliable connection point.

#### ✓ KEEPS UP WITH EVOLVING TECHNOLOGY

- It is PoE ready and the perfect match with 10GXS cable for next generation applications.
- One termination method supports all Category 5e through Category 6A cable connections.
- Technology has been developed with future industry standards in mind.
- It supports emerging technologies, IP convergence and standards recommendations.

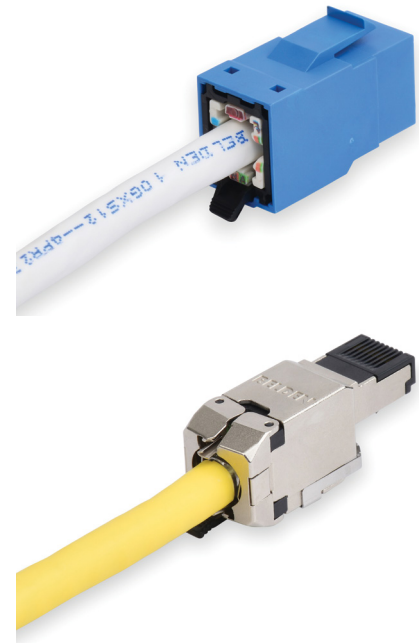

REVConnect incorporates a single reliable and easy termination method that offers unparalleled versatility.

**> FOR MORE DETAILS VISIT [ANIXTER.COM/SHOPBELDEN](http://ANIXTER.COM/SHOPBELDEN)**

**About Anixter:** [anixter.com/aboutus](http://anixter.com/aboutus)  
**Legal Statement:** [anixter.com/legalstatement](http://anixter.com/legalstatement)

At Anixter, we enable the connected world. By building, connecting, protecting and powering valuable assets and critical infrastructures, we help to sustain and grow businesses and communities worldwide. We accomplish this by offering full-line solutions, technical intelligence, supply chain expertise and an unmatched global distribution network.

1.800.ANIXTER | [anixter.com](http://anixter.com)

