

PRODUCT SOLUTIONS BRIEF
COMMSCOPE

HEALTHCARE FACILITY NETWORK PERFORMANCE

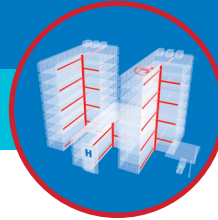

Through our strong global partnerships and alliances with manufacturers such as CommScope®, we are able to present you with the following offering to meet your specific healthcare facility requirements.

ION®-E Series

CommScope's ION-E Series simplifies the design, deployment and operations of the in-building wireless system. The all-digital unified wireless infrastructure helps operators maximize the use of existing and future IT cabling infrastructure. ION-E transports capacity to wherever it's needed in real time by using a software-defined switch and distribution method. The system's simplicity helps operators meet their healthcare clients' current needs, while positioning them for long-term success—no matter if it is for inpatient services, outpatient services or in the data center.



ION-E central area node (CAN) and universal access point

CHALLENGE SOLVERS

- It is the ideal solution for healthcare customers who need reliable coverage to support multiple communication services such as in-house mobile radios, paging, emergency responders along with in-building cellular coverage for physicians, patients and families.
- Unified wireless infrastructure delivers a more flexible network, making it easy to deploy, configure and optimize in-building wireless solutions quickly and cost-effectively.
- This revolutionary solution simplifies the inherent complexities that are involved in deploying in-building wireless systems while addressing current and future needs of wireless operators, building owners and tenants.
- The system leverages options that are more affordable and available with the use of Category 6A copper and multimode or single-mode fiber cabling.

THE ANIXTER APPROACH

- **Network Flexibility**
Apply open-architecture designs to accommodate your performance requirements for a highly scalable network.
- **Media Selection**
Choose the appropriate physical media from twisted-pair and optical to address high-speed bandwidth requirements.
- **Wireless Mobility**
Determine your migration path for Wi-Fi and in-building cellular connectivity to support a multi-screen environment.
- **Application Support**
Deploy scalable designs that can support multiple and varied applications over an IP-based structured cabling system.

THE COMMSCOPE SOLUTION

WCS UNIT	SUBRACKS	POWER SUPPLY
2U 4U	CAN (central area node) e-POI (ION-E point of interface) TEN (transport expansion node) UAP (universal access point)	12 V DC 57 V DC

anixter.com/shopcommscope

COMMSCOPE®

WHAT WE HEAR

Healthcare stakeholders are dealing with a variety of challenges:



Keeping up with **EVOLVING TECHNOLOGIES**



AMORTIZATION of cabling system investment



Supporting multiple **APPLICATIONS**



Reducing network **DOWNTIME**



Coping with **INCREASING BANDWIDTH**

Infrastructure as a Platform
by Anixter

Infrastructure as a Platform by Anixter offers a standards-based, physical layer approach that provides a foundation to meet the high-performance networking demands of your healthcare facility.

CONFIGURE

We help you discover and map your specific needs to the best solution.

- Transport media
- WCS subracks
- Universal access point
- UPS

BUNDLE

Your validated, preconfigured solutions are packaged and site ready.

- Information outlets
- Fiber connectors
- SYSTIMAX® cords
- imVision®

DEPLOY

Controlled, repeatable solutions are delivered on time and under budget.

- Custom packaging and labeling
- Time-sensitive delivery options
- Staged project shipping
- Tailored last-mile delivery

COMMSCOPE ION-E FEATURES

✓ FLEXIBLY SERVE HEALTHCARE ENVIRONMENTS

- Connected via Category 6A cabling, which also supports a 1G pass-through for Wi-Fi, IP cameras or other 1G Ethernet devices
- Support for 600–2700 MHz frequencies with one model
- MCC, MNC and cell ID detection for ease of signal distribution

✓ ENSURE UBIQUITOUS NETWORK AVAILABILITY

- Innovative and intuitive user interface allow for easy setup and configuration with minimum input required.
- The multiband, multioperator and multitechnology platform is designed with a standard grid approach and on-demand software defined frequencies to adapt to changing requirements.
- Gigabit Ethernet back-haul over common infrastructure means no separate cables or hardware are required.



Simplicity, scalability and flexibility make ION-E ideal for healthcare customers.

> FOR MORE DETAILS VISIT [ANIXTER.COM/SHOPCOMMSCOPE](https://www.anixter.com/shopcommscope)

About Anixter: [anixter.com/aboutus](https://www.anixter.com/aboutus)

Legal Statement: [anixter.com/legalstatement](https://www.anixter.com/legalstatement)

At Anixter, we enable the connected world. By building, connecting, protecting and powering valuable assets and critical infrastructures, we help to sustain and grow businesses and communities worldwide. We accomplish this by offering full-line solutions, technical intelligence, supply chain expertise and an unmatched global distribution network.

1.800.ANIXTER | [anixter.com](https://www.anixter.com)



17T8487NA © 2018 Anixter Inc.

Products. Technology. Services. Delivered Globally.