

PRODUCT SOLUTIONS BRIEF
CHATSWORTH PRODUCTS

HEALTHCARE FACILITY NETWORK PERFORMANCE

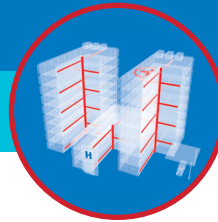

Through our strong global partnerships and alliances with manufacturers such as Chatsworth Products (CPI), we are able to present you with the following offering to meet your specific healthcare requirements.

N-Series TeraFrame® Gen 3 Network Cabinet System

CPI's N-Series TeraFrame Gen 3 Network Cabinet System supports multiple applications under network performance. In addition to network and storage environments, the N-Series offers airflow management and control.

CHALLENGE SOLVERS

- Patented side-intake duct adjustable to support any switch size on site
- Vertical exhaust duct option and compatibility with both hot- and cold-aisle containment configurations
- Frame design for proper clearance for side airflow switches

THE ANIXTER APPROACH

• **Network Flexibility**

Apply open-architecture designs to accommodate your performance requirements for a highly scalable network.

• **Cabling Topology**

Determine the right choice for an open-architecture environment by adopting healthcare facility wiring and building automation standards.

• **Application Support**

Deploy scalable designs that can support multiple and varied applications over an IP-based structured cabling system.

THE CPI SOLUTION

DIMENSIONS	DOOR/PANEL OPTIONS	CABINET ACCESS CONTROL
Height Width Depth	Front Rear Top Side	Latch and lock kits
anixter.com/shopcpi		



Complete airflow isolation for high-density network and storage switches



CHATSWORTH PRODUCTS

WHAT WE HEAR

Healthcare stakeholders are dealing with a variety of challenges:



Keeping up with **EVOLVING TECHNOLOGIES**



AMORTIZATION of cabling systems



Supporting multiple **APPLICATIONS**



Reducing network **DOWNTIME**



Coping with **INCREASING BANDWIDTH**

Infrastructure as a Platform by Anixter offers a standards-based, physical layer approach that provides a foundation to meet the high-performance networking demands of your healthcare facility.

CONFIGURE

We help you discover and map your specific needs to the best solution.

- Form factor and a color
- Airflow manager
- Doors and latches
- Panels and cable entry style

BUNDLE

Your validated, preconfigured solutions are packaged and site ready.

- Blanking panels
- Cable management
- eConnect® PDUs
- Aisle containment

DEPLOY

Controlled, repeatable solutions are delivered on time and under budget.

- Custom packaging and labeling
- Time-sensitive delivery options
- Staged project shipping
- Tailored last-mile delivery

CPI N-SERIES TERAFRAME FEATURES

✓ KEEPS UP WITH EVOLVING TECHNOLOGIES

- Engineered cabinet designed for high-density network and storage applications
- Wider network cabinet compatible with F-Series TeraFrame and GF-Series GlobalFrame server cabinets
- Design that offers maximum cable management flexibility from either side of cabinet
- Flexibility for mounting equipment, thermal, cable and power management accessories

✓ REDUCES NETWORK DOWNTIME

- Complete separation of hot and cold air within the cabinet
- Vertical exhaust duct available to maintain airflow segregation strategy
- Preconfigured to include front-to-rear, front-to-top, side-to-rear and side-to-top airflow
- A universal side airflow solution to eliminate switch-specific accessories



Vertical exhaust duct option to maintain airflow segregation

> FOR MORE DETAILS VISIT [ANIXTER.COM/SHOPCPI](https://www.anixter.com/shopcpi)

About Anixter: [anixter.com/aboutus](https://www.anixter.com/aboutus)
Legal Statement: [anixter.com/legalstatement](https://www.anixter.com/legalstatement)

At Anixter, we enable the connected world. By building, connecting, protecting and powering valuable assets and critical infrastructures, we help to sustain and grow businesses and communities worldwide. We accomplish this by offering full-line solutions, technical intelligence, supply chain expertise and an unmatched global distribution network.

1.800.ANIXTER | [anixter.com](https://www.anixter.com)

